

# *Flyin' West*

*by Pearl Cleage*



**Director:** Dr. Lundeana M. Thomas

**Stage Manager:** Jessica Moskowitz

**Set Designer/TD:**

Nicholas Hilliard

**Paint Charge:**

Madison Grant

**Props Master:**

Surena Arnall

**Fight Choreographer:**

Connor Hammond

**Costume Designer:**

Hannah Jackson

**Lighting Designer:**

Marcus Randolph

**Master Electrician:**

Tristan Mitchell

**Sound Designer:**

Stuart Beaman

# FLYIN' WEST

# October 2016

Sunday	Monday	Tuesday	Wednesday	Thursday	Friday	Saturday
						1
2	3	4	5	6	7	8
9	10 <b>6:30-10:30</b> Intro, Character analysis, Read thru  (UNG Rehearsal Hall)	11 <b>6:30-10:30</b> Block 1.1  (UNG Rehearsal Hall)	12 <b>6:30-10:30</b> Block 1.1 and 1.2  (UNG Rehearsal Hall)	13 <b>6:30-7:30</b> Work sister ritual <b>7:30-10:30</b> Block 1.3 (UNG Rehearsal Hall)	14	15
16 <b>12:00-6:00</b> Block 1.4 and 1.5, Run Act One (UNG Rehearsal Hall) <i>7:00 RepCo Show</i>	17 <b>6:30-10:30</b> Block 2.1, 2.2, and 2.3  (Ed Cabell Theatre)	18 <b>6:30-10:30</b> Block 2.4, 2.5, and 2.6	19 <b>6:30-8:00</b> Work transitions <b>8:00-10:30</b> Run Act Two	20 <b>6:30-8:00</b> Work transitions <b>8:00-10:30</b> Run Act One	21	22
23 <b>12:00-2:30</b> Run Act One <b>3:00-6:00</b> Run Act Two	24 <b>ACT 1 OFF BOOK!</b> <b>6:30-7:30</b> Work Frank and Minnie fight scene <b>7:45-10:30</b> Work Act One	25 <b>ACT 2 OFF BOOK!</b> <b>6:30-7:30</b> Work death scene <b>7:45-10:30</b> Work Act Two	26 <b>6:30-10:30</b> Talk, Complete transitions, review fight and death scenes	27 <b>6:30-10:30</b> Run Show	28 <b>BIOS DUE</b>	29 <i>Halloween Cabaret</i>
30 <b>3:00-9:00</b> Run Show	31 <b>6:30-10:30</b> Work Act One (try to run twice)					

\*Schedule is subject to change

# FLYIN' WEST

# November 2016

Sunday	Monday	Tuesday	Wednesday	Thursday	Friday	Saturday
		1 <b>6:30-10:30</b> Work Act Two (try to run twice)	2 <b>6:30-10:30</b> Work Show with All Props	3 <b>6:30-10:30</b> Run Show – Designers Invited	4 <b>6:30-10:30</b> Run Show – Tech Watch	5
6 <b>3:00-8:00</b> Tech Act One	7 <b>6:00-11:00</b> Tech Act Two	8 <b>6:00-11:00</b> Tech Full Show	9 <b>6:00-11:00</b> 1 <sup>st</sup> Dress Rehearsal	10 <b>7:30-10:00</b> Invited Dress Rehearsal	11 <b>7:30-10:00</b> Opening Night	12 <b>5:00-6:00</b> Photo Shoot <b>7:30-10:00</b> Performance
13 <b>7:30-10:00</b> Performance	14 <b>7:30-10:00</b> Closing Night	15	16	17	18	19
20	21	22	23	24	25	26
27	28	29	30			

\*Schedule is subject to change



# October 2016 Production Team

Sunday	Monday	Tuesday	Wednesday	Thursday	Friday	Saturday
						1
2	3 <b>*Begin costume measurements</b>	4	5	6	7	8
9	10 <b>5:00-6:00</b> Tape out set (RH) <b>6:30-10:30</b> Rehearsal (UNG Rehearsal Hall)	11 <b>3:30-Done</b> Tape out set (RH) <b>6:30-10:30</b> Rehearsal (UNG Rehearsal Hall)	12 <b>6:30-10:30</b> Rehearsal (UNG Rehearsal Hall)	13 <b>5:00-6:00</b> Production Meeting <b>6:30-10:30</b> Rehearsal (UNG Rehearsal Hall)	14	15
16 <b>12:00-6:00</b> Rehearsal (UNG Rehearsal Hall) <i>7:00 RepCo Show</i>	17 <b>LIGHT PLOT DUE</b> <b>6:30-10:30</b> Rehearsal (Ed Cabell Theatre)	18 <b>6:30-10:30</b> Rehearsal	19 <b>6:30-10:30</b> Rehearsal	20 <b>5:30-6:30</b> Production Meeting <b>6:30-10:30</b> Rehearsal	21	22
23 <b>12:00-6:00</b> Rehearsal	24 <b>6:30-10:30</b> Rehearsal	25 <b>6:30-10:30</b> Rehearsal	26 <b>6:30-10:30</b> Rehearsal	27 <b>5:30-6:30</b> Production Meeting <b>6:30-10:30</b> Rehearsal	28	29 <i>Halloween Cabaret</i>
30 <b>3:00-9:00</b> Rehearsal	31 <b>LOAD IN</b> <b>6:30-10:30</b> Rehearsal <b><i>HALLOWEEN!</i></b>					

\*Schedule is subject to change



# November 2016 Production Team

Sunday	Monday	Tuesday	Wednesday	Thursday	Friday	Saturday
		1 6:30-10:30 Rehearsal	2 <b>ALL PROPS DUE</b> 6:30-10:30 Rehearsal	3 5:30-6:30 Production Meeting 6:30-10:30 Rehearsal – Designers Invited	4 6:30-10:30 Tech Watch	5
6 2:00-2:30 Gun Test 3:00-8:00 Tech Act One <b>*Director's Note &amp; Bios due to Beth</b>	7 6:00-11:00 Tech Act Two	8 6:00-11:00 Tech Full Show <b>*Resume food props</b>	9 6:00-11:00 1 <sup>st</sup> Dress Rehearsal	10 7:30-10:00 Invited Dress Rehearsal	11 7:30-10:00 Opening Night	12 5:00-6:00 Photo shoot 7:30-10:00 Performance
13 7:30-10:00 Performance	14 7:30-10:00 Closing Night	15	16	17	18	19
20	21	22	23	24	25	26
27	28	29	30			

\*Schedule is subject to change



**GAINESVILLE THEATRE ALLIANCE DISCOVERY SERIES 2016 - FLYIN' WEST CONTACT SHEET**

**DESIGNERS**

Dr. Lundeana Thomas	Director	[REDACTED]	[REDACTED]
Amanda Washington	Assistant to the Director	[REDACTED]	[REDACTED]
Jessica Moskowitz	Stage Manager	jsmosk2985@ung.edu	954-937-4248
Alaina Holeman	Assistant Stage Manager	[REDACTED]	[REDACTED]
Lauren Raper	Assistant Stage Manager	[REDACTED]	[REDACTED]
Nick Hilliard	Set Designer	[REDACTED]	[REDACTED]
Madison Grant	Paint Charge	[REDACTED]	[REDACTED]
Surena Arnall	Props Master	[REDACTED]	[REDACTED]
Hannah Jackson	Costume Designer	[REDACTED]	[REDACTED]
Marcus Randolph	Lighting Designer	[REDACTED]	[REDACTED]
Tristan Mitchell	Master Electrician	[REDACTED]	[REDACTED]
Stuart Beaman	Sound Designer	[REDACTED]	[REDACTED]
Connor Hammond	Fight Choreographer	[REDACTED]	[REDACTED]
Adam Washington	Fight Captain	[REDACTED]	[REDACTED]

**CREW**

Asa Stephens	Gun Wrangler	[REDACTED]	[REDACTED]
Aurora Miller	Run Crew	[REDACTED]	[REDACTED]
Corrinna Redford	Wardrobe Crew Head	[REDACTED]	[REDACTED]
Sierra Benning	Wardrobe Run Crew	[REDACTED]	[REDACTED]
Princess Sampson	Wardrobe Run Crew	[REDACTED]	[REDACTED]
Jesse Smith	Wardrobe Run Crew	[REDACTED]	[REDACTED]
Matthew Sand	Light Board Operator	[REDACTED]	[REDACTED]
Edward Adams	Sound Board Operator	[REDACTED]	[REDACTED]
Brissa Lopez	House Manager	[REDACTED]	[REDACTED]
Elyssa Pate	House Manager	[REDACTED]	[REDACTED]
Nathaniel Rigney	House Manager	[REDACTED]	[REDACTED]

**CAST**

Jaymyria Etienne	Sophie	[REDACTED]	[REDACTED]
Annette Grevious	Miss Leah	[REDACTED]	[REDACTED]
Ameena McKenzie	Fannie	[REDACTED]	[REDACTED]
Kennedy Salters	Minnie	[REDACTED]	[REDACTED]
Adream Thompson	Frank	[REDACTED]	[REDACTED]
Adam Washington	Wil Parrish	[REDACTED]	[REDACTED]



**GAINESVILLE THEATRE ALLIANCE DISCOVERY SERIES 2016 - FLYIN' WEST**

**DESIGNERS**

Dr. Lundeana Thomas	Director	None
Amanda Washington	Assistant to the Director	Cherries
Jessica Moskowitz	Stage Manager	Penicillin
Alaina Holeman	Assistant Stage Manager	Does not eat pork
Lauren Raper	Assistant Stage Manager	None
Nick Hilliard	Set Designer	Augmentin, cats
Madison Grant	Paint Charge	Amoxicillin
Surena Arnall	Props Master	None
Hannah Jackson	Costume Designer	Amoxicillin
Marcus Randolph	Lighting Designer	None
Tristan Mitchell	Master Electrician	Pescatarian
Stuart Beaman	Sound Designer	None
Connor Hammond	Fight Choreographer	None

**CREW**

Asa Stephens	Gun Wrangler	None
Aurora Miller	Run Crew	None
Corrinna Redford	Wardrobe Crew Head	Coffee, tree pollen, dust, grass, bugs
Sierra Benning	Wardrobe Run Crew	None
Princess Sampson	Wardrobe Run Crew	None
Jesse Smith	Wardrobe Run Crew	None
Matthew Sand	Light Board Operator	Pollen, pet dander (mild)
Edward Adams	Sound Board Operator	None
Brissa Lopez	House Manager	None
Elyssa Pate	House Manager	None
Nathaniel Rigney	House Manager	None

**CAST**

Jaymyria Etienne	Sophie	Pineapples, cats (taking birth control, fluoxetine, hydroxyzine)
Annette Grevious	Miss Leah	Bananas, peaches, cats
Ameena McKenzie	Fannie	Carrots
Kennedy Salters	Minnie	Mild lactose intolerance (minimal straight dairy), cats
Adream Thompson	Frank	Penicillin
Adam Washington	Wil Parrish/Fight Captain	Pollen



Character Scene Breakdown  
Version #2  
10-17-16



KEY	
X	Onstage and has lines
(X)	Onstage and has no lines

SCENE		1.1	1.2	1.3	1.4	1.5	2.1	2.2	2.3	2.4	2.5	2.6	SCENE
PAGES		7-23	23-26	27-38	39-43	43-48	49-51	52-57	57-59	59-65	66-68	69-71	PAGES
Character	Actor												Character
Miss Leah	Annette Grevious	X	(X)	X	X		X	X	X	X	(X)	X	Miss Leah
Sophie	Jaymyria Etienne	X	X	X	(X)	X	X	X	X	X	(X)	X	Sophie
Wil Parish	Adam Washington	X	X	X				X		X	(X)	X	Wil Parish
Fannie	Ameena McKenzie	X	X	X	(X)	X	X	X	X	X	X	X	Fannie
Minnie	Kennedy Salters		X	X	X	X	X	X	(X)	X	(X)	X	Minnie
Frank	Adream Thompson		X	X	X	X	(X)	X	X		X		Frank

**NOTES**

- 1.2** Miss Leah enters at the top of the scene and during the middle of the scene to set the table for the 1.3 dinner.
- 1.4** Fannie and Sophie enter at the end of the scene to clean dishes in the kitchen.
- 2.1** Frank enters at the end of the scene and paces downstage of the porch.
- 2.3** Minnie enters at the end of the scene from the bedroom.
- 2.5** Miss Leah, Sophie, Will, and Minnie are in this scene, but do not have any lines.





Rehearsal Props List  
Version #1  
10-12-16



Prop	A/Sc/Pg	#	Description	Received?
Silver Flask	1.5.46; 2.2.55	1	Frank's flask. Filled with drinking water.	X
Plates	1.1.17; 1.3.26; 2.2.52	6	Plates used to eat meals. Used by all cast members.	X
Bowls	1.3.26	6	Bowls used for dinner in 1.3. Used by all cast members.	X
Forks	1.1.17; 1.3.26; 2.2.52; 2.5.67	6	Utensils for eating. Used by all cast members.	X
Spoons	1.1.17; 1.3.26	6	Utensils for eating. Used by all cast members.	X
Knives	1.1.17; 1.3.26; 2.4.64; 2.5.67	6	Utensils for eating. Used by all cast members.	X
Glasses (Cups)	1.1.8; 1.1.17; 1.3.26; 2.1.49; 2.2.52; 2.4.60	6	Glasses for drinking water. Used by all cast members.	X
Wine Glasses	1.3.26	3	Glasses for drinking wine (juice). Used by Frank, Wil, and Sophie	X
Corn Whiskey Glass	1.3.26	1	Square-shaped glass for corn whiskey.	X
Wine Bottle	1.3.26	1	Bottle with juice for wine.	X
Shotgun (Wooden)	1.1.7; 1.2.25; 1.3.26; 1.4.43; 1.5.46; 2.1.49; 2.2.52; 2.3.58; 2.4.59; 2.5.68; 2.6.69	1	Wooden rolling pin to roll out pie crust.	X
Wooden Spoon	2.4.60	1	For mixing pie ingredients.	X
Rolling Pin	2.4.64	1	Wooden rolling pin to roll out pie crust.	X
Blanket	2.1.49	1	For Minnie.	X
Candle	1.1.17	1	Candle for dinner table.	X
Small Book	1.2.25	1	A small book of poetry. Frank's gift to Fannie. Kept in Frank's suitcase.	X
Large Book	1.3.27	1	Frank's book.	X
Coffee Pot	1.1.8; 1.5.44; 2.3.59	1	Hangs on fireplace. Contains hot drinking water.	X
Tea Kettle	2.1.49; 2.4.60	1	Hangs on fireplace. Contains sweet tea.	X
Basket	2.1.49	1	Blanket from Minnie's bedroom	X
Matches	1.1.8; 1.4.39	10	Long, wooden matches to light tobacco pipe	X
Cigar	1.3.38	1	Wooden fake cigar used by Frank.	X



Props Preset List  
11.6.16  
V.3



**Pre- Show**

- ❖ Props Check Out
- ❖ Take 2 Guns, Wil's Knife, Kitchen Knives & Mink out of David Becker's Office
- ❖ Wipe down table

**Top of Show**

❖ **Porch**

- 4 Flower Pots
- Side Table (Porch Left)
- 1 Flower for Fannie to grab

❖ **Sink**

- 8 Rags
- 4 Cups
- 2 Tub (round silver and black can  
Can under the Sink is what will  
be used instead of the green  
tub)
- 3 Knives
- Coffee Grounds
- 3 Small Herb Jars
- 3 Big Herb Jars
- Apple Pie Ingredients (Nutmeg,  
Cinnamon,Flour,Sugar)

❖ **Fireplace**

- Matches
- 4 Large Herb jars
- Fire Stoker
- Tall Candle
- Water Jug

❖ **Fannie's Desk**

- Oil Can
- Letter
- Blueprint
- Deed for Minnie & Sophie
- Gun Shells (2)
- Pencil and Paper (Sophie's  
speech)

- Rag

❖ **Bedroom**

- Oil lamp (mantel)
- 1 male brush (mantel)
- 1 female brush (mantel)

❖ **Sideboard**

- China Set (Inside)
- 3 Dishes
- 6 wine glasses
- 8 water cups
- Wine Decanter
- 3 Small Herb Jars
- 1 Tall candle
- 6 Saucers w/Angel Food cut on  
them (inside)
- 1.1 Food) Sliced Turkey/Corn  
(inside) (all on 3 individual  
plates)
- 1.3 Food (6 biscuits) Set inside
- 6 Plates
- 6 Knives
- 6 Spoons
- 6 Forks
- 6 Napkins
- 2.2 Food (Bacon/Half a biscuit)  
(inside)\*

❖ **Kitchen Table**

- Salt & Pepper Shakers
- 1 Tall candle

❖ **USR Vom**

- 1.3 Food (Fried  
Chicken/Mashed  
potatoes/Green beans)
- 2.4 Food (Pie Tin, Pie Dough, Pie  
Utensils, Basket of Apples,Basket  
for peels, Bucket of Water)\*

**\* ONLY USED IN ACT TWO**

JSM, ANH, LMR



Props Preset List  
11.6.16  
V.3



**POST SHOW**

❖ **USL Vom**

- Canvas Bag of Groceries
  - Tobacco
- Bag of Flour
- Brush
- Male Comb
- Sewing Materials
- Cradle
- Baby
- Sophie's Gun

❖ **DSR Vom**

- Oil Lamp
- Basket of Flowers
- Bouquet of Flowers 1.1
- Wil's Knife
- Stone
- Milk Pail
- Telegraph\*
- Small Packet\*
- Bouquet of Flowers 2.6\*
- Wil's Gun\*

❖ **DSL Vom**

- Book of Poetry
- 4 suitcases
- *Uncle Tom's Cabin* Book For Frank
- Cigar
- Sliver Flask\*

❖ Props Check In

- ❖ Take 2 Guns, Wil's Knife, Kitchen Knives, & Mink and lock up in David Becker's Office
- ❖ Wash ALL dishes
- ❖ Dispose of leftover food
- ❖ Clean Flask
- ❖ Clean Pipe
- ❖ Clean Cigar
- ❖ Sweep Stage
- ❖ Put back Flower Fannie grabbed

**\* ONLY USED IN ACT TWO**

JSM, ANH, LMR

## ***Flyin' West* Fight & Lift Call List**

20 minutes – Give actors a 10-minute warning

1. Dining Room Fight – Frank, Minnie, Fannie, Sophie
2. Bedroom Fight – Frank, Minnie
3. Lifting Frank – Frank, Wil

## ***Flyin' West* Sound Cues as of 11.2.2016**

1. Pre-show music: African-American 19<sup>th</sup> Century spirituals (Burleigh, Fisk Jubilee, etc.), "We Believe in Freedom Ella's Song" – Sweet Honey in the Rock?
2. Cricket/owl sounds at the top of 1.1
3. Rustling in bushes sound at the beginning of 1.1 – could possibly be a bear, causes Sophie to pause and lift her rifle
4. Page 7: Gunshot (single shot, double-barrel shotgun)
5. Train entering
6. Train slowing to a stop
7. Train exiting
8. Page 26: Music playing while people leave the train station and go back to the house
9. Page 38 (Ritual): "We Believe in Freedom/Ella's Song" (Slower) – Sweet Honey in the Rock
10. Page 39 (Top of 1.4): Rooster crow
11. Page 39 (Top of 1.4): Music playing
12. Page 48 (End of Act One): Music playing
13. Gun click (double-barrel shotgun)
14. Intermission music: African-American 19<sup>th</sup> Century spirituals (Burleigh, Fisk Jubilee, etc.)
15. Page 49 (Top of Act Two): "I Want Jesus"
16. Frank and Minnie fight: Aria of woman singing (Dr. Thomas will provide song)
17. Page 68: Music for Frank's death
18. Baby cooing – no crying, up close
19. Curtain Call: "We Believe in Freedom Ella's Song" (Faster) – Sweet Honey in the Rock
20. Post-show music: African-American 19<sup>th</sup> Century spirituals (Burleigh, Fisk Jubilee, etc.)

## ***Flyin' West* Photo Shoot List**

### **Act One**

1. Gun Shot, Scene 1.1, page 7
  - a. Cast: Sophie
  - b. Crew: Asa
  - c. Props: Sophie's gun, lantern, bags
  - d. Lights: LQ 10
2. "Roses were her favorites," Fannie sitting on porch, Wil has foot on porch, Scene 1.1, page 14
  - a. Cast: Fannie, Wil
  - b. Props: Flower basket
  - c. Lights: LQ 11
3. "Secrets already?" Scene 1.2, page 25
  - a. Cast: Fannie, Sophie, Minnie, Frank
  - b. Props: Luggage
  - c. Lights: LQ 20
4. "Thank you for this food we are about to receive," Scene 1.3, page 30
  - a. Cast: ALL
  - b. Props: 1.3 Dinner
  - c. Lights: LQ 30
5. "And all our love," Scene 1.3, page 38
  - a. Cast: Sophie, Fannie, Minnie
  - b. Lights: LQ 31
6. "Don't you think Frank is fine looking?" Scene 1.4, page 39
  - a. Cast: Minnie, Miss Leah
  - b. Props: Comb, Pipe
  - c. Lights: LQ 40
7. "I'm going to have a baby!" Scene 1.5, page 48
  - a. Cast: Frank, Minnie, Sophie, Fannie
  - b. Crew: Asa
  - c. Props: Sophie's gun
  - d. Lights: LQ 52

## ***Flyin' West* Photo Shoot List**

### **Act Two**

8. "For better or for worse," Scene 2.1, page 51
  - a. Cast: Fannie, Minnie, Frank, Sophie
  - b. Lights: LQ 60
9. "Happy Birthday, Min," Scene 2.2, page 53
  - a. Cast: Sophie, Fannie, Miss Leah, Minnie, Frank
  - b. Props: Deed
  - c. Lights: LQ 70
10. "I'll kill you right now, Min," Scene 2.2, page 57
  - a. Cast: Frank, Minnie
  - b. Lights: LQ 72
11. "...and just holler about it as loud as I want to holler," Scene 2.4, page 61
  - a. Miss Leah, Minnie
  - b. Lights: LQ 91
12. "She gave me her recipe for apple pie," Scene 2.4, page 65
  - a. Miss Leah, Sophie, Fannie
  - b. Props: Apple pie ingredients
  - c. Lights: LQ 93
13. "My god, help me! Please help me!" Scene 2.5, page 68
  - a. Frank, Fannie
  - b. Props: Apple pie slice, plate, fork
  - c. Lights: LQ 102
14. Fannie giving the gun to Sophie, Scene 2.5, page 68
  - a. Fannie, Sophie
  - b. Props: Sophie's gun
  - c. Lights: LQ 103
15. "All these fine colored women, makin' a place for you," Scene 2.6, page 71
  - a. Miss Leah, Fannie, Sophie, Minnie
  - b. Props: Baby
  - c. Lights: LQ 112
16. Cast Picture – Scene 2.6 costumes (Frank in 2.5 costume)
  - a. All Cast
  - b. Lights: LQ 115
17. Cast and Crew Picture
  - a. All Cast, All Crew
  - b. Lights: LQ 115
18. Crew Picture
  - a. All Crew
  - b. Lights: LQ 115

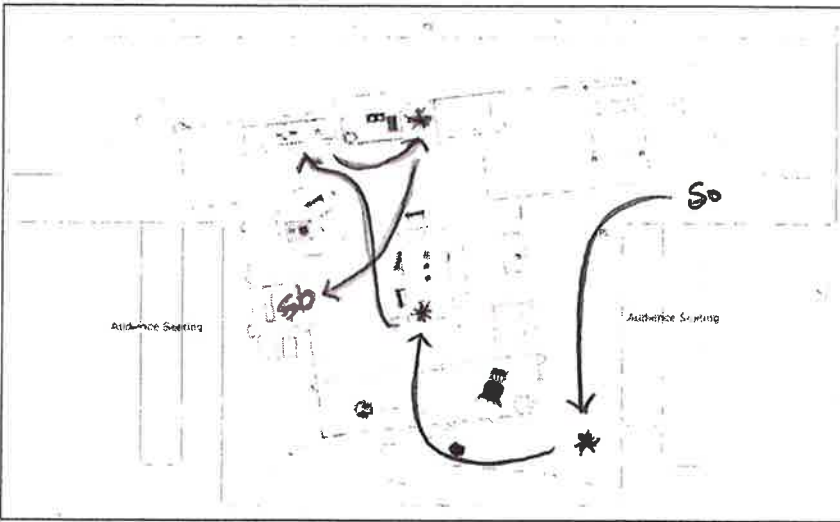

1. So En USL, X ↓ → DSL
2. So drop bags, point gun @ DSL, then DSL, then fire in air
3. So pick up bags, X ↑ house
4. So set bags on TT, set shotgun + lamp on mantle USC
6. So X → coat rack hang up jacket
5. So X ↓ ML, stoke ML
7. So X ↓ desk, ↓, prop up legs, eat licorice

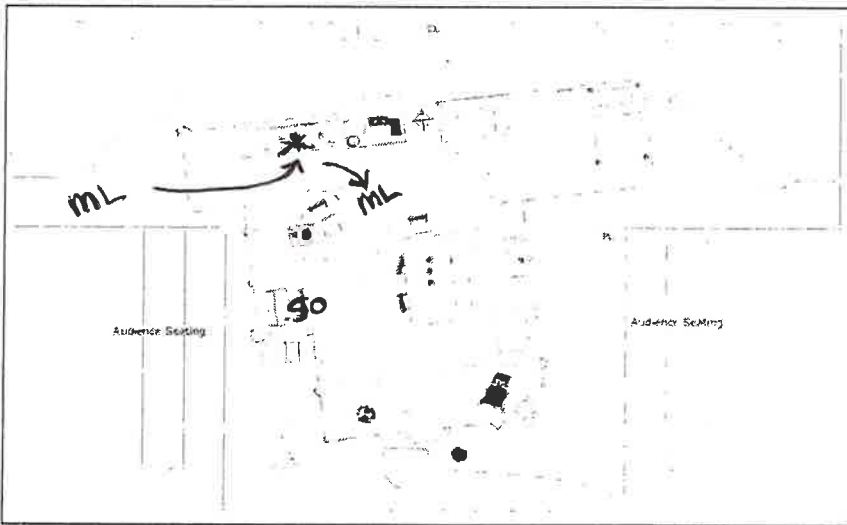

8. ML En USR, X → ML
9. ML X SL, land USR of TT

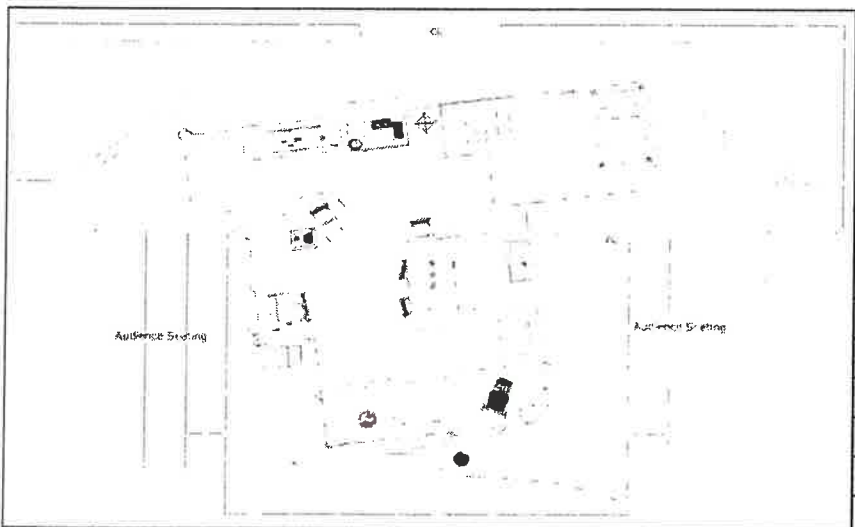



STBY SQ 1 + LQ 5

STBY SQ 8 + LQ 6 + House 1/2

SQ 1 + LQ 5

Preshow @ 7:05

Places

Actors to Places @ 7:25

# FLYIN' WEST

SQ 8 + LQ 6 + House to 1/2

Curtain Speech

STBY SQ 9 + LQ 7 + House Out

Post curtain speech  
Blue out - when speaker safely out of light

SQ 10 + LQ 10

Top of Act One

STBY SQ 9 + LQ 7 + House Out

STBY SQ 10 + LQ 10

STBY SQ 13

STBY SQ 14

ACT ONE

To Jessica  
Thank you  
Leah Pearl  
Clear

## Scene 1

Sophie enters rapidly. Her heavy coat is unbuttoned and her scarf flies out around her neck. It is chilly, but the cold has exhilarated her. She has just returned from a trip into town. She has a large bag of flour slung over her shoulder and a canvas shoulder bag full of groceries. She is carrying a shotgun, which she places by the door. She slings the bag of flour carelessly on the table and, coat still on, puts the other bag on a chair. She fumbles through her pockets, first withdrawing a letter, which she holds for a moment thoughtfully, then sticks in the growing pile on the overflowing desk. She fumbles through her pockets again and withdraws some long strips of black licorice. She takes a bite, sighs, chews appreciatively. She pulls a chair over to the window, opens it wide and sits down, propping her booted feet up on the window sill. She looks out the window with great contentment, takes another bite of licorice and chews slowly, completely satisfied with the candy's sweetness, the chill in the air and the privacy of the moment.

Miss Leah enters haltingly. She walks unsteadily but has no cane to steady herself, so she holds onto the furniture as she walks slowly into the room. She is looking for something and her manner is exasperated. Sophie does not notice her entering. Miss Leah looks at Sophie, immediately notices the open window and her irritation increases.

SQ 13

So DSL 2

SQ 14

So En House 3

STBY SQ 15

STBY ML En

STBY SQ 16

SQ 15

So stoke Mill 5

ML En

SQ 16

After ML En 8  
"We who Believe in Freedom"  
\*call right before dialogue!

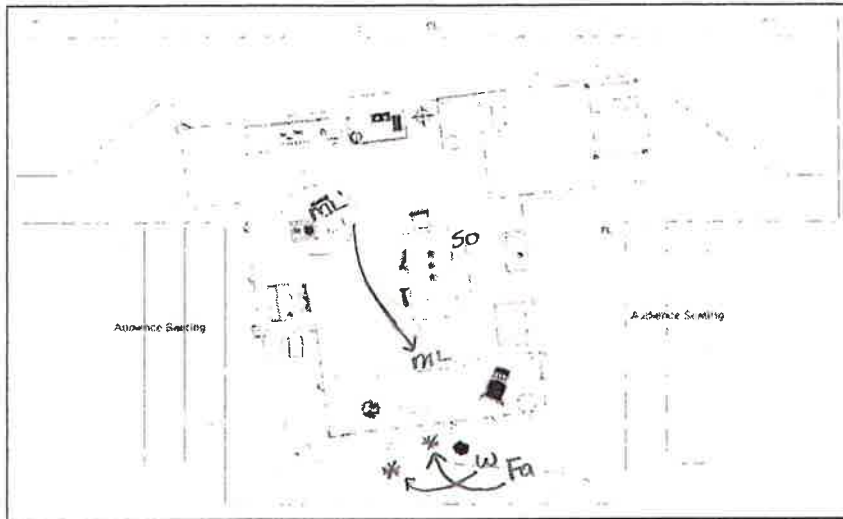

1. ML  $\downarrow$ , X DSC  $\rightarrow$  door
2. Fa X  $\leftarrow$   $\rightarrow$  DSC of porch
3. W step SR

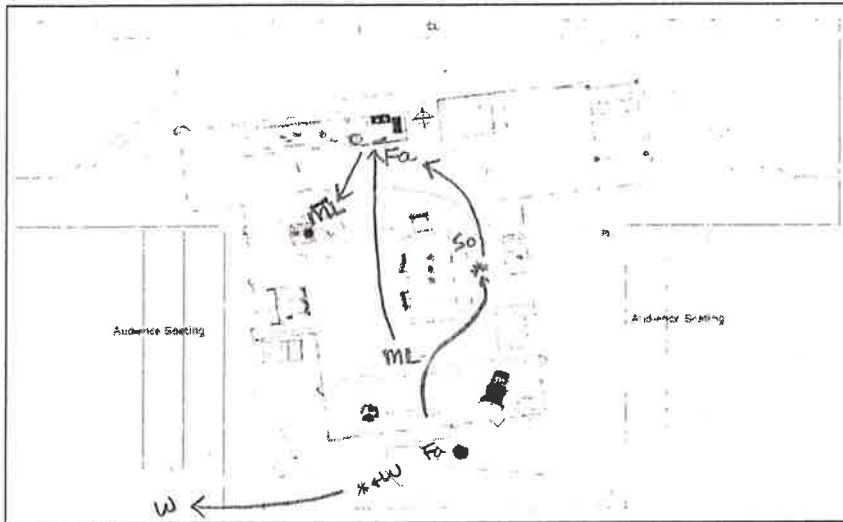

4. W step DSR
5. Fa step  $\rightarrow$  W, W G  $\rightarrow$  Fa
6. Fa put  $\$3$  in W's button hole
7. W EX DSR
8. Fa En house, X  $\uparrow$  TT
9. ML X  $\uparrow$  sink w/ cup
10. Fa X  $\rightarrow$  sink, pat ML
11. ML X  $\rightarrow$  CS h,  $\downarrow$

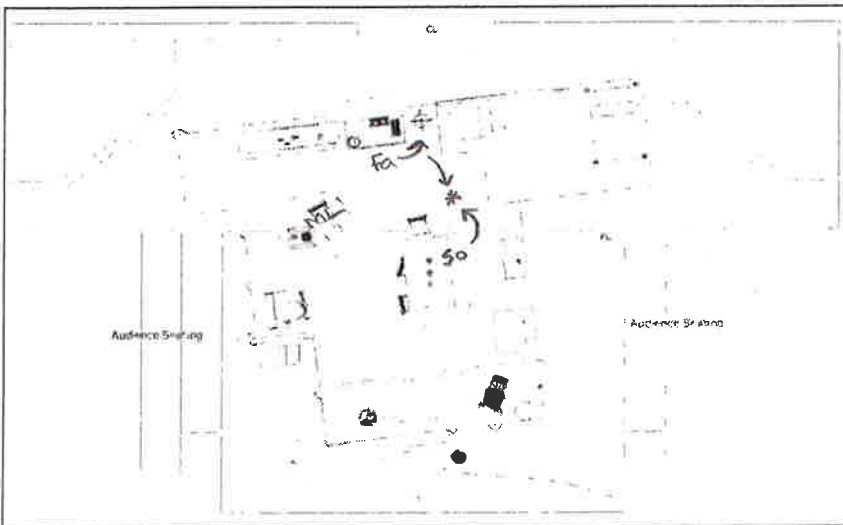

12. Fa X  $\rightarrow$  coat rack, take off jacket, put on apron
13. So X  $\rightarrow$  Fa, tie apron
14. ML G  $\rightarrow$  Fa

WIL. Walkin' with you has been the pleasure of my day.

STBY SQ 20

FANNIE. Would you like some coffee before you start back?

After "day"

WIL. No, thanks. I want to catch the last of the light. Give my best to your sister.

STBY SQ 21+LQ 12

After STBY SQ 20

FANNIE. I will.

WIL. And Miss Leah.

FANNIE. Yes, I will.

WIL. Tell her ... Miss Leah ... maybe I'll stop in ... tomorrow?

FANNIE. We'll look for you.

WIL. Well, good evening then.

FANNIE. Good evening. <sup>(4)</sup> *(He starts off. Miss Leah comes to the window and watches the parting.)* <sup>(5)</sup> Wil ... *(He turns back hopefully. Fannie walks to him and puts a flower in his button hole.)* <sup>(6)</sup> Take this for company on your way back.

WIL. Why, thank you! I do thank you.

FANNIE. Good evening, Wil.

WIL. And to you ... Miss Fannie. <sup>(7)</sup> *(He tips his hat and walks off, adjusting the flower in his button hole. Fannie watches him until he is gone, then walks slowly to the house. Miss Leah returns to her seat and begins humming "Amazing Grace." Sophie looks at her. She continues humming loudly and rocking with a smug look on her face.)*

SQ 20

W EX DSR (3)

(WAIT?)

SQ 21+LQ 12

Fa En House (8)

SOPHIE. What is it?

MISS LEAH. I ain't said a word to you.

SOPHIE. You're humming at me!

MISS LEAH. I ain't hummin' at nobody. I am just hummin'. *(Fannie enters with flowers.)*

FANNIE. I'm sorry to be so late!

MISS LEAH. Sophie made coffee.

SOPHIE. She's been humming at me ever since. <sup>(12)</sup> *(Fannie kisses Sophie's cheek and pats Miss Leah.)*

FANNIE. Everything is fine at your place, Miss Leah. *(She puts the flowers in water and arranges them quickly around the room.)*

MISS LEAH. Everythin's fine but me.

FANNIE. Aren't you feeling good? <sup>(13)</sup>

MISS LEAH. I'm too old to feel good. <sup>(14)</sup> How's Wil Parrish feelin'?



breakfast before we go out? My coffee isn't as bad as Sister's.  
MISS LEAH. (1) Fan left me a fresh pot. Go ahead, chile. I'll  
be fine. I've been up long enough to be lookin' for a nap  
oon. (2) *(Frank and Minnie exit to the yard.)*

FRANK. (Angrily.) I want you to put your hair back the way  
it was. (3)

MINNIE. I always wore my ...

FRANK. You look like a damn picaninny! We haven't been  
here twenty-four hours and look at you.

MINNIE. I'm sorry ...

FRANK. You're always sorry, aren't you? (4) Of course you are,  
but if you weren't so busy being sorry, you'd know there are  
some interesting things going on in Nicodemus these days.

MINNIE. What do you mean?

FRANK. (5) Nothing. I'm going to ~~ride~~ into town to check at  
the telegraph office and ... take a look around.

MINNIE. Don't be too late, will you? (6) *(He exits. Minnie sits  
down on the porch wearily and draws her knees to her chest, rocking  
back and forth wearily. In the kitchen, Fannie and Sophie are obli-  
vious.)* (7) (11)

## BLACKOUT

## Scene 5

*It is late that evening. Sophie and Fannie and Minnie are  
up. Fannie is sewing something. Sophie is pulling some pa-  
pers from her desk. Some of these are rolled maps or plans,  
etc. These are Sophie's plans for the development of the town.  
Minnie is standing at the window. Fannie takes off her  
glasses, rubs her eyes sleepily. Minnie goes over to the fire  
and stirs it up, puts another log on.*

FANNIE. Well, I think I'm going to leave the rest to you  
night owls! Don't worry. Nicodemus isn't big enough for Frank  
to get into trouble, even if he's looking for it.

LQ 42

When mi steps on  
porch (2)

STBY SQ 33

STBY LQ 43

STBY SQ 35+ LQ 50

SQ 33

Fr X DSL  
"Raven" + "Oh Freedom"

LQ 43

When sisters hug mi (8)

SQ 35+ LQ 50

When song says  
" \* And Be Free " (11)

*Flyin' West*  
 Rehearsal Report | #22  
 11.7.2016 (Monday)

**Team:**

**Director:** Dr. Lundeana Thomas

**Stage Manager:** Jessica Moskowitz

**ASMs:** Alaina Holeman, Lauren Raper

**Began:** 6:03    **Ended:** 11:00

**Attended:**

**Cast** – Jaymyria Etienne, Annette Grevious, Ameena McKenzie, Kennedy Salters, Adream Thompson, Adam Washington

**Crew** – Dr. Thomas, Amanda Washington, Jessica Moskowitz, Alaina Holeman, Lauren Raper, Surena Arnall, Nick Hilliard, Aurora Miller, Tristan Mitchell, Marcus Randolph, Corrinna Redford, Matthew Sand, Asa Stephens

**Late** – Edward Adams (20 min., called, excused)

**Faculty** – Stuart Beaman

Rehearsal Breakdown		
Time	Action	Called
6:03-6:23	Fight Call	Adream, Kennedy, Adam, Jaymyria, Ameena
6:23-6:48	Work Ritual	All Cast
6:48-6:53	Break	All
6:52-7:15	Braid Minnie's Hair	Corrinna, Minnie
7:15-9:20	Cue-to-Cue Act Two	All Cast, All Crew
9:20-9:35	Break	All
9:35-9:41	Work Bows	All Cast
9:41-10:33	Tech Act Two (0:50)	All Cast, All Crew
10:33-10:43	Break	All
10:43-11:00	Notes	All Cast

Rehearsal Notes
1. Today we teched Act Two! Act Two ran 0:50.
Costumes
1. Thank you for bringing Sophie's coat and Minnie's hair clip and wig!
Set
1. We had a fireplace malfunction at the beginning of our Cue-to-Cue. The lamp melted through the plastic dome. Marcus will look into this tomorrow.
Props
1. Thank you for taping out the props tables!
Lighting
1. We had a fireplace malfunction at the beginning of our Cue-to-Cue. The lamp melted through the plastic dome. <b>Marcus will look into this tomorrow.</b>

*Flyin' West*  
 Rehearsal Report | #22  
 11.7.2016 (Monday)

Sound
<ol style="list-style-type: none"> <li>1. Jessica will no longer call SQ 28.</li> <li>2. Jessica will no longer call SQ 57.</li> <li>3. <b>ADD cues for crickets to fade in and fade out in Scene 2.4.</b> They will fade in on page 59 when Fannie and Wil enter DSR (before SQ 51.5), and they will fade out on page 60 after Wil says "they ain't that much different from any other kind of man when you get down to it" (with LQ 91).</li> </ol>
Stage Management
<ol style="list-style-type: none"> <li>1. Nothing tonight, thanks.</li> </ol>
Miscellaneous
<ol style="list-style-type: none"> <li>1. We will be having a brief costume parade at the start of rehearsal on Tuesday.</li> <li>2. We will resume using real food on Tuesday.</li> </ol>

Next Rehearsal: Tuesday, 11.8.2016		
Time	Action	Called
6:00-6:45	Costume Parade	All Cast, Costumes, Lights
6:45-7:00	Rework Blocking	Kennedy, Adam, Jaymyria, Ameena
7:00-7:20	Fight Call	Adream, Kennedy, Adam, Jaymyria, Ameena
7:30-8:50	Tech Act One	All Cast, All Crew
9:00-10:00	Tech Act Two	All Cast, All Crew
10:10-11:00	Notes	All Cast

*Flyin' West*  
Production Meeting Report | #3  
10.27.2016 (Thursday)

**Team:**

**Director:** Dr. Lundean Thomas  
**Stage Manager:** Jessica Moskowitz  
**ASMs:** Alaina Holeman, Lauren Raper  
**Began:** 5:34                      **Ended:** 6:34

**Attended:**

**Present** – Dr. Thomas, Amanda Washington, Jessica Moskowitz, Alaina Holeman, Lauren Raper, Surena Arnall, Madison Grant, Nick Hilliard, Hannah Jackson, Tristan Mitchell, Marcus Randolph, Corrinna Redford, Asa Stephens  
**Faculty** – Larry Cook, Aimee Johnson (FaceTime), Celeste Morris  
**Guests** – Sara Pekrul

**Props**

1. Surena and David went shopping for all of the non-perishable food.
2. We cannot have the apple pie-scented spray, due to allergy concerns and potentially setting off the fire alarm.
3. **Larry and Dr. Thomas will discuss possibilities for serving food in the safest possible way.** We are considering building a heating unit onstage.
4. Wil will have his knife with him for the entire show, not just 1.3. His sheath will attach to a gun belt.

**Set**

1. Nick gave Jessica a ground plan with the roof layer removed. **He will send her a PDF of that ground plan as soon as possible.**
2. Dr. Thomas no longer wants to have a staircase coming from the bedroom.
3. We want to have a small border of railing around the edge of the bedroom.
4. Left to build: box beam, back wall, building in the air, and the burlap.
5. We have reworked the blocking to remove the CSL Exit. **The step that was used for that exit will need to be removed.**
6. Set will put up the white cyc as one of their last steps.
7. Nick will arrange the wood in the fireplace to accommodate the lighting and wood that will be added during the show.

**Costumes**

1. Hannah has pulled a few costume options for Dr. Thomas to wear for opening night. Hannah provided a map so that Dr. Thomas will be able to find the costume shop.
2. **Hair:**
  - a. Adam's hair will be left as-is.
  - b. Adream will have his hair relaxed next week, and be styled with a side part and a wave.
  - c. Jaymyria's hair will be left in her current braids, and will be styled with a bun and scarves and/or hats in order to make her hair look less modern.
  - d. Annette's hair will be left as-is, and styled in a bun with scarves/head wraps.
  - e. Kennedy's hair will be kept as-is. She will have a styled hairpiece and a fall. She will wear the fall in 1.4 and 1.6. She will wear the hairpiece for all of the other scenes.
  - f. Ameena's hair will be kept as-is, with a part down the middle and a top bun and comb.



*Flyin' West*  
Production Meeting Report | #3  
10.27.2016 (Thursday)

**Costumes (Continued)**

3. **Facial Hair:** We will not have any facial hair in this production.
4. **Jessica will give Hannah entrance and exit times for each of the actors' quick changes.**
5. There will be a costume work call for *Flyin' West* on Saturday from 10 am – 6 pm.
6. Corrinna Redford will **not** be coming onstage as a doctor character.
7. We do not want to have suspenders for Wil. Wil will have a belt throughout the entire play, and a separate gun belt for his knife sheath.
8. **We need rehearsal costumes for the train station and church scenes – Fannie, Sophie, and Miss Leah will need hats and cowls/capelets/shawls.**
9. Marcus will come by the costume shop tomorrow around 1:00 pm to test light swatches against the costumes.

**Lights**

1. **Marcus will come by the costume shop tomorrow around 1:00 pm to test light swatches against the costumes.**
2. Load-in for lights is Monday, October 31.
3. After load-in and the non-saturated color is dropped, Marcus will make a rehearsal look.
4. Marcus will have colors and effects on the cyc.
5. Roberto will be creating lighting effects for the fireplace.
6. We will have a lighting effect at end of Act One – dimming throughout last moment, and ending with lights just on the actors' faces at the last line of the Act, just before the blackout.

**Sound**

1. **Stuart will meet with the stage management team to teach them how to use the sound software for rehearsals.**
2. **Jessica will reach out to Edward, our Sound Board Operator, to make sure that he is able to attend our next production meeting.**

**Miscellaneous**

1. **Jessica will send out an email to the designers to schedule paper tech.**
2. Asa Stephens has agreed to be our gun wrangler!
3. We want to have a crew member making clapping and smacking noises during the Frank and Minnie fight in the bedroom.
4. Larry spoke to us about our participation in the American College Theatre Festival. We are considered an Associate Production, which means we will not go on to compete in the Festival, but scholarships and opportunities will be tied to it for everyone involved. A total of 3 actors, and the designers, can be entered into further competitions in order to win awards and scholarships. The adjudicator will come for one evening of *Flyin' West*, and give us a talk-back of their responses following that show. Requirements for each designer's submissions are listed on their website.
5. **Larry will speak to Box Office to see if it is possible to change our current rating of PG to PG13.**

*Flyin' West*  
Production Meeting Report | #3  
10.27.2016 (Thursday)

Next Production Meeting: Thursday, 11.3.2016		
Time	Action	Called
5:30-6:30	Final Production Meeting	Designers



# Production Report | 2

Production: *Flyin' West*

Director: Dr. Lundeana Thomas

Stage Manager: Jessica Moskowitz

Date: 11.12.2016

House Count: 115 | Total Run Time: 2:01

## WEATHER

52°

Cloudy

### Preshow Checklist

X	Fight Call
X	Charge Glow Tape
X	Props Preset
X	Costumes Preset
X	Cue Preshow Lights and Sound

### Time Record

	Time	Run Time
House Open	7:10-7:34	0:24
Act One	7:37-8:46	1:09
Intermission	8:46-9:01	0:15
Act Two	9:01-9:53	0:52

### Attendance

**House Manager:** Sydney Rohrbaugh

**Present:** All Cast and All Crew

**Absent:** None

**Late:** None

**Injury/Illness:** None

### Summary

1. We had our production photo shoot today before the show!
2. We held the house for four minutes before curtain speech due to late audience members.
3. We received a standing ovation and loud applause for each actor during bows.

### Performance Notes

1. Our audience laughed throughout the entire show, and during unexpected moments. Miss Leah and Wil received the most laughs tonight. The biggest laughs came from Miss Leah and Sophie's conversation in 1.1; Fannie's "I'm going to find the station manager;" Minnie's "Please to be met;" Wil's "Not a colored man, but I guess they ain't that much different...;" Miss Leah's "Don't any of those New Orleans negroes know how to use a shotgun?" "He'll do," "He ain't that pretty," "Which shows he ain't as smart as he thinks he is;" during the Frank and Minnie fight; during the pie-making scene, and Miss Leah's dialogue in 2.6.
2. We received loud applause following scenes 1.2, 1.3, when Wil carried Frank's body out, and when Sophie and Fannie exited after 2.5.

### Technical Notes

1. We will set the fader to 4 at pre-show, and Jessica will call for the fader to be moved back to 0 after the pre-show music fades down.
2. The fresnel that is used for the blue cyc light is burning through the gels, so Matthew disconnected the fresnel before tonight's performance. This resulted in the blue being less full than what was designed. Marcus will look at this tomorrow.



# Production Report | 2

Production: *Flyin' West*

Director: Dr. Lundean Thomas

Stage Manager: Jessica Moskowitz

Date: 11.12.2016

House Count: 115 | Total Run Time: 2:01

WEATHER

52°

Cloudy

## Next Performance: Sunday, 11.13.2016

Time	Action	Called
5:30	Costume Crew Call	Costume Crew
6:00	Crew Call	All Crew
6:00-6:20	Fight & Lift Call	Adream, Kennedy, Adam
6:20-7:25	Prep for Run	All Cast, All Crew
7:25	Places	All Cast, All Crew
7:30-Done	GO	All Cast, All Crew